



**4 Longstone Court*, Station Road, Letterston.,
Haverfordwest, Pembrokeshire, SA62 5RQ**

A Semi Detached Three Bedroom House, Comprises entrance hallway, fitted kitchen, WC, spacious living / dining room with patio doors leading out to the enclosed rear garden. First floor Family bathroom, Master bedroom with en suite shower room, a further double bedroom and one single room. Allocated parking for two cars. Pets Considered. EPC Rating C. Rent £750 pcm and Deposit £850.00 NB: Holding Deposit of one week's rent to secure the property for up to one month will be required. Please call us to book a viewing and for further details of this property and the application



RENT: £750 PCM

DEPOSIT: £850

40 High Street, Haverfordwest, Pembrokeshire, SA61 2DA info@westwaleshomerentals.co.uk

Ground Floor

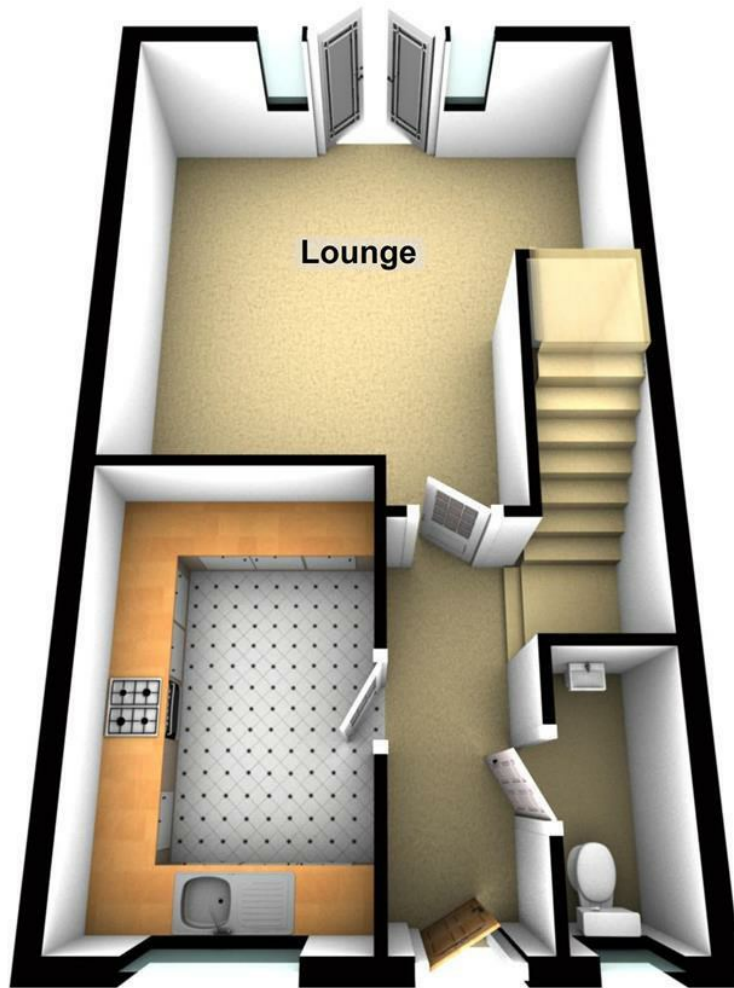

This floor plan has been designed as a visual aid to identify room names and positioning within the building. Some doors, windows or fittings may be incorrectly sized or positioned as these are included for identification purposes only. This is not a working drawing and is not to scale.

Plan produced using PlanUp.

4 Longstone Court, Letterston

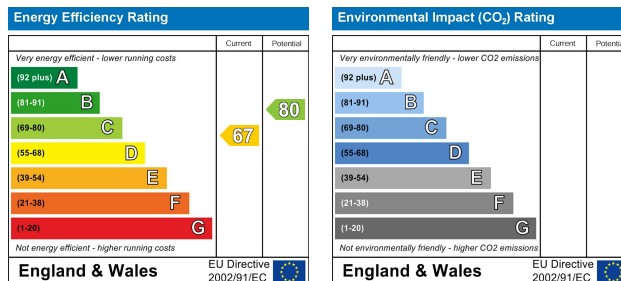

The particulars are set out as a general outline only for the guidance of intended purchasers or lessees, and do not constitute, any part of a contract. Nothing in these particulars shall be deemed to be a statement that the property is in good structural condition or otherwise nor that any of the services, appliances, equipment or facilities are in good working order. Purchasers should satisfy themselves of this prior to purchasing.

COMPUTER-LINKED OFFICES THROUGHOUT WEST WALES and Associated Office in Mayfair, London

Lorne House St Julian's Street, Tenby, Pembrokeshire, SA70 7AS

EMAIL:

TELEPHONE: 01437 762288